

VERTICAL FIRE DAMPERS

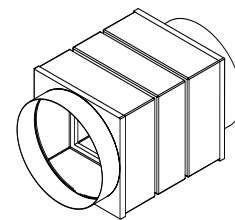

VFD-10-D-IS

- "A" style dynamic dampers stocked.
- Wall style vertical mount for 1 or 2 hour walls.
- 12", 20 gauge galvanized steel sleeve.
- U.L. file #R11767.
- C.S.F.M. file #3225-368:101.
- Optional SSPF picture frame angles.
- Optional AR or AR1 units come with round collar(s) loose.



Vertical Mount
(Model - VFD-10D-ISAR shown above.
Optional round duct connection is a U.L.
approved breakaway connection.)

Size	Stock#	List Price
6" x 6"	W-11617	\$61.00
8" x 8"	W-11618	\$61.00
10" x 10"	W-11619	\$67.00
12" x 12"	W-11620	\$67.00
14" x 14"	W-11621	\$82.00
16" x 16"	W-11622	\$82.00
18" x 18"	W-11623	\$104.00
20" x 20"	W-11624	\$104.00
22" x 22"	W-11625	\$131.00
24" x 24"	W-11626	\$131.00

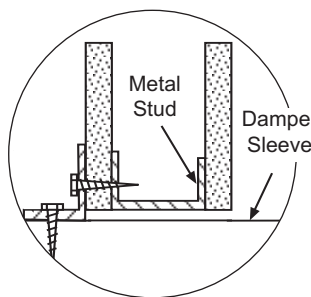

Single Mounting Angle
Over Drywall

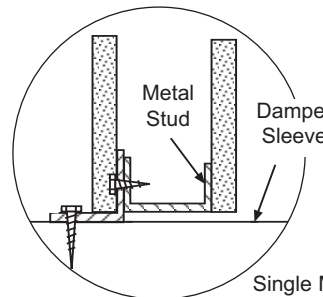

Single Mounting Angle
UNDER Drywall
* Metal Stud Only

Mounting Angles

FIRE/SMOKE DAMPERS AND FIRE DAMPERS SQUARE-TO-ROUND ADAPTORS



- The Fire/Smoke Dampers and Fire Dampers Square-to-Round Caps will not fit on the Ceiling Radiation Dampers.

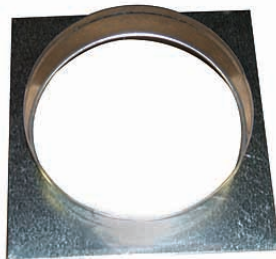

Size	Stock#	List Price
6"x6"x6"	W-11637	\$9.00
8"x8"x6"	W-11638	\$11.00
8"x8"x8"	W-11639	\$11.00
10"x10"x8"	W-11640	\$13.00
10"x10"x10"	W-11641	\$13.00
12"x12"x10"	W-11642	\$14.00
12"x12"x12"	W-11643	\$14.00
14"x14"x12"	W-11644	\$15.00
14"x14"x14"	W-11645	\$15.00
16"x16"x14"	W-11646	\$16.00
16"x16"x16"	W-11647	\$16.00
18"x18"x16"	W-11648	\$17.00
18"x18"x18"	W-11649	\$17.00
20"x20"x18"	W-11650	\$18.00
20"x20"x20"	W-11651	\$18.00
22"x22"x20"	W-11652	\$20.00
22"x22"x22"	W-11653	\$20.00
24"x24"x22"	W-11654	\$27.00
24"x24"x24"	W-11655	\$27.00

Accessory Reference		
		
SSPF Angle - pg. 6	Access Doors - pg. 14-20	Warnock Hersey Angle Set - pg.6